

**ATTENTION :**

**WARNING :**

Choisir les pièces détachées en fonction du type de la cuve. La cuve complète ou le cutter complet étant parfaitement interchangeable, dans tous les cas choisir respectivement les repères 5 ou 1.

Choose the spare parts in accordance with the bowl type. As the complete bowl or the cutter attachment are fully interchangeable, for all types choose respectively item 5 or 1.

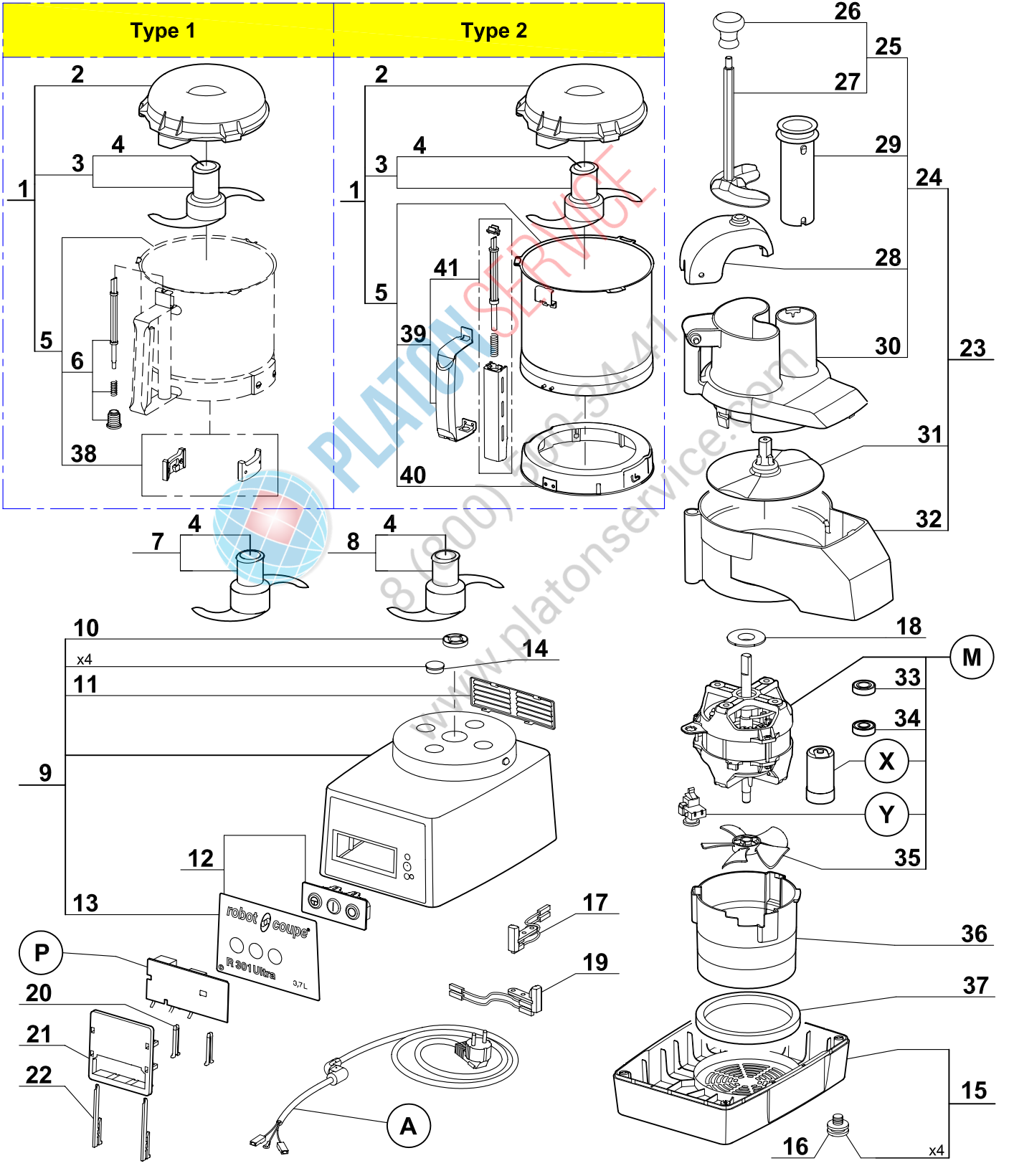
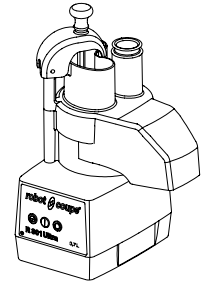

| Index | Pièce / Part   | Désignation                         | Description                    |
|-------|----------------|-------------------------------------|--------------------------------|
| 1     | <b>27 278</b>  | CUTTER COMPLET                      | CUTTER ATTACHEMENT             |
| 2     | <b>117 395</b> | COUVERCLE CUTTER                    | CUTTER LID                     |
| 3     | <b>27 286</b>  | COUPEAU LISSE                       | STRAIGHT BLADE                 |
| 4     | <b>104 147</b> | CAPUCHON COUPEAU                    | BLADE CAP                      |
| 5     | <b>39 759</b>  | ENS. CUVE CUTTER                    | CUTTER BOWL ASSEMBLY           |
| 6     | <b>39 228</b>  | ENS. TIGE SECURITE                  | SAFETY ROD ASSEMBLY            |
| 7     | <b>27 287</b>  | COUPEAU DENTE                       | FINE SERRATED BLADE            |
| 8     | <b>27 288</b>  | COUPEAU CRANTE                      | SERRATED BLADE                 |
| 9     | <b>39 317</b>  | ENS. SUPPORT MOTEUR                 | MOTOR SUPPORT ASSEMBLY         |
| 10    | <b>501 010</b> | BAGUE ETANCHEITE                    | SHAFT SEAL                     |
| 11    | <b>104 122</b> | GRILLE VENTILATION                  | VENTILATION GRID               |
| 12    | <b>39 293</b>  | ENS. TABLEAU COMMANDE               | CONTROL PANEL ASSEMBLY         |
| 13    | <b>407 834</b> | PLAQUE FRONTALE                     | FRONT PLATE                    |
| 14    | <b>104 121</b> | CAPSULE CACHE VIS                   | BOLT COVER                     |
| 15    | <b>39 288</b>  | ENS. SOCLE                          | BASE ASSEMBLY                  |
| 16    | <b>101 082</b> | PIED                                | FOOT                           |
| 17    | <b>29 356</b>  | INTERRUPTEUR SECURITE COUPE-LEGUMES | VEGETABLE SLICER SAFETY SWITCH |
| 18    | <b>104 078</b> | CENTREUR MOTEUR                     | MOTOR CENTRING                 |
| 19    | <b>29 451</b>  | INTERRUPTEUR SECURITE CUTTER        | CUTTER SAFETY SWITCH           |
| 20    | <b>102 913</b> | CLAVETTE PLASTRON                   | PANEL KEY                      |
| 21    | <b>102 911</b> | SUPPORT PLATINE                     | CONTROL BOARD SUPPORT          |
| 22    | <b>117 703</b> | CLAVETTE FIXE PLATINE               | CONTROL BOARD KEY              |
| 23    | <b>27 295</b>  | ENS. COUPE-LEGUMES                  | VEGETABLE SLICER ASSEMBLY      |
| 24    | <b>39 287</b>  | ENS. COUVERCLE COUPE-LEGUMES        | VEGETABLE SLICER LID ASSEMBLY  |
| 25    | <b>29 880</b>  | ENS. POUSSOIR LEGUMES               | VEGETABLE PUSHER ASSEMBLY      |
| 26    | <b>102 021</b> | POIGNEE                             | HANDLE KNOB                    |
| 27    | <b>103 703</b> | POUSSOIR LEGUMES                    | VEGETABLE PUSHER               |
| 28    | <b>104 922</b> | GUIDE POUSSOIR                      | PUSHER GUIDE                   |
| 29    | <b>118 324</b> | POUSSOIR CAROTTES                   | ROUND PUSHER                   |
| 30    | <b>104 919</b> | COUVERCLE COUPE-LEGUMES             | VEGETABLE SLICER LID           |
| 31    | <b>104 921</b> | DISQUE EVACUATEUR                   | SLING PLATE                    |
| 32    | <b>104 918</b> | CUVE COUPE-LEGUMES                  | VEGETABLE SLICER BOWL          |
| 33    | <b>504 229</b> | ROULEMENT MOTEUR SUPERIEUR 6002 2RS | UPPER BALL-BEARING 6002 2RS    |
| 34    | <b>600 457</b> | ROULEMENT MOTEUR INFERIEUR 6201 2RS | LOWER BALL-BEARING 6201 2RS    |
| 35    | <b>117 610</b> | VENTILATEUR MOTEUR                  | MOTOR FAN                      |
| 36    | <b>104 110</b> | CONDUIT VENTILATION                 | VENTILATION BAFFLE             |
| 37    | <b>101 099</b> | TAMPON AMORTISSEUR                  | ABSORBER                       |
| 38    | <b>29 081</b>  | ENS. PLAQUETTE                      | LOCKING PLATE ASSEMBLY         |
| 39    | <b>39 752</b>  | ENS. POIGNEE CUVE                   | BOWL HANDLE ASSEMBLY           |
| 40    | <b>39 797</b>  | ENS. RONDELLE D'ACCROCHAGE          | LOCKING WASHER ASSEMBLY        |
| 41    | <b>39 751</b>  | ENS. TIGE SECURITE                  | SAFETY ROD ASSEMBLY            |

| <i>Index</i>       | <i>Désignation</i>        | <i>Description</i>   |          |          |          |          |
|--------------------|---------------------------|----------------------|----------|----------|----------|----------|
| <b>A</b>           | CABLE D'ALIMENTATION      | POWER CORD           |          |          |          |          |
| <b>M</b>           | MOTEUR                    | MOTOR                |          |          |          |          |
| <b>P</b>           | CARTE DE COMMANDE         | CONTROL BOARD        |          |          |          |          |
| <b>X</b>           | CONDENSATEUR DE DEMARRAGE | STARTING CAPACITOR   |          |          |          |          |
| <b>Y</b>           | RELAIS DEMARRAGE MOTEUR   | MOTOR STARTING RELAY |          |          |          |          |
| <b>Machine</b>     | <b>Voltage</b>            | <b>A</b>             | <b>M</b> | <b>P</b> | <b>X</b> | <b>Y</b> |
| 22 377 UK          | 240/50/1                  | 504 275              |          |          |          |          |
| 2 447 UK           |                           |                      |          |          |          |          |
| 2 540 Pack 4D UK   |                           |                      |          |          |          |          |
| 22 378 Aust        |                           | 504 278              |          |          |          |          |
| 2 542 Pack 4D Aust |                           |                      |          |          |          |          |
| 22 379 DK          | 230/50/1                  | 504 276              | 3 074    | 103 693  | 600 018  | 500 289  |
| 2 550 DK           |                           |                      |          |          |          |          |
| 22 403 CH          |                           | 504 292              |          |          |          |          |
| 2 418 CH           |                           |                      |          |          |          |          |
| 2 417 Pack 4D CH   |                           |                      |          |          |          |          |
| 22 375             |                           |                      |          |          |          |          |
| 2 547              |                           | 504 274              |          |          |          |          |
| 2 546 Pack 4D FR   |                           |                      |          |          |          |          |
| 2 545 Pack 3D ALL  |                           |                      |          |          |          |          |
| 2 544 Pack 4D SWE  |                           |                      |          |          |          |          |
| 2 548 Pack 5D OST  |                           |                      |          |          |          |          |
| 22 380             | 220/60/1                  |                      | 3 075    |          | 603 669  |          |
| 2 543              |                           |                      |          |          |          |          |
| 22 381             | 120/60/1                  | 504 277              | 3 076    | 103 692  |          | 500 296  |
| 2 541              |                           |                      |          |          |          |          |